

## VC-Series

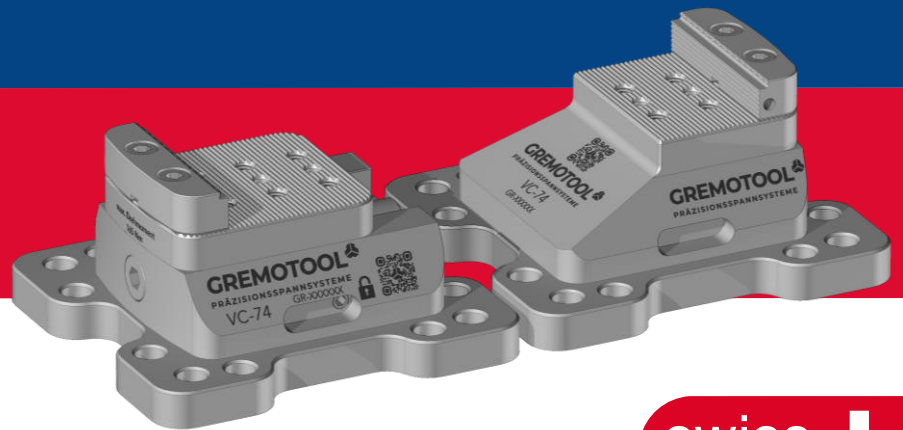

# Overview

VC-Series

---

Product presentation	3
Overview of size options	6
Sizing guide	7
Torque range	9
Dimension	11
VC-60	11
VC-74	15
VC-100	19
VC-120	23
VC-150	27
Applications	31
Accessories	32
Impressum	34

# Product presentation

## VC-Series

With the VC series, you enable your production to clamp large panels with a flexible clamping system. The clamping width is not dependent on the clamping device, as the two modules can be positioned independently of each other on the table or perforated grid plate. These can also be rotated by 30° to enable the production of round parts. Due to the same height as the LC series, the VC and LC series can be combined without adaptation.

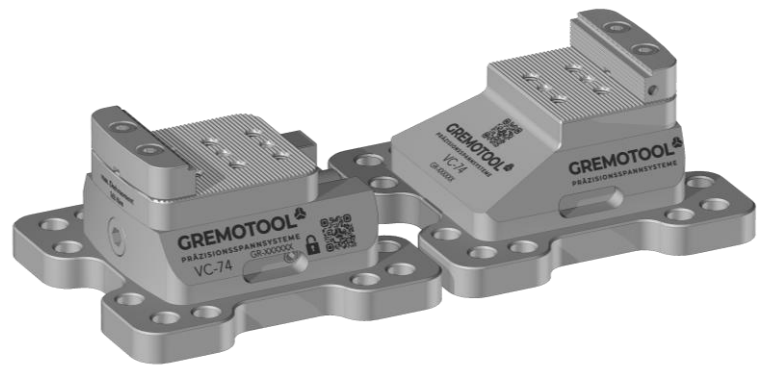

# Product presentation

## Benefits of the VC-Series

---

### Clamping Force

The high clamping forces of the VC series can be influenced via the torque on the spindle. This allows you to clamp plastic workpieces without deformation and forged parts with a secure hold without destroying the clamp.

### Accessibility

The flat silhouette of the VC series enables installation on all panels, towers and pyramids with maximum workpiece sizes. The perfected design of the clamp minimises interfering contours on both sides.

### Flexibility

The elaborate drilling pattern of the two standard base variants covers perforated panels with 40- and 50-mm grid. The modules can be mounted on the panel independently and rotated by 30°. This enables complex clamping up to an approximate three-jaw chuck.

### Compact

The compact clamp fits on any plate or tower to enable large tensions. Its low weight facilitates manual set-up.

### Low maintenance

Thanks to its compact design, the chips do not remain anywhere in the clamp. The spindle remains free of chips, which minimises maintenance.

### Short set-up times

The VC series can be equipped with various connection options. The standard base from Gremotool is suitable for grooved tables and perforated grid plates. Solutions for pallet systems and zero-point clamping systems can also be offered.

### Large range of jaws

The entire range of Gremotool jaws can be used on the VC series. From gripper jaws to soft jaws made of aluminium, no wishes remain unfulfilled when it comes to workpiece clamping requirements.

The jaws are equipped with the standardised Gremotool jaw system. This allows you to change the jaws very fast.

### Locking function

The clamping module has a locking screw to block it. This function allows soft jaws to be precisely adjusted to the workpiece without the need for a boring ring or external fixings.

# Product presentation

VC-Series

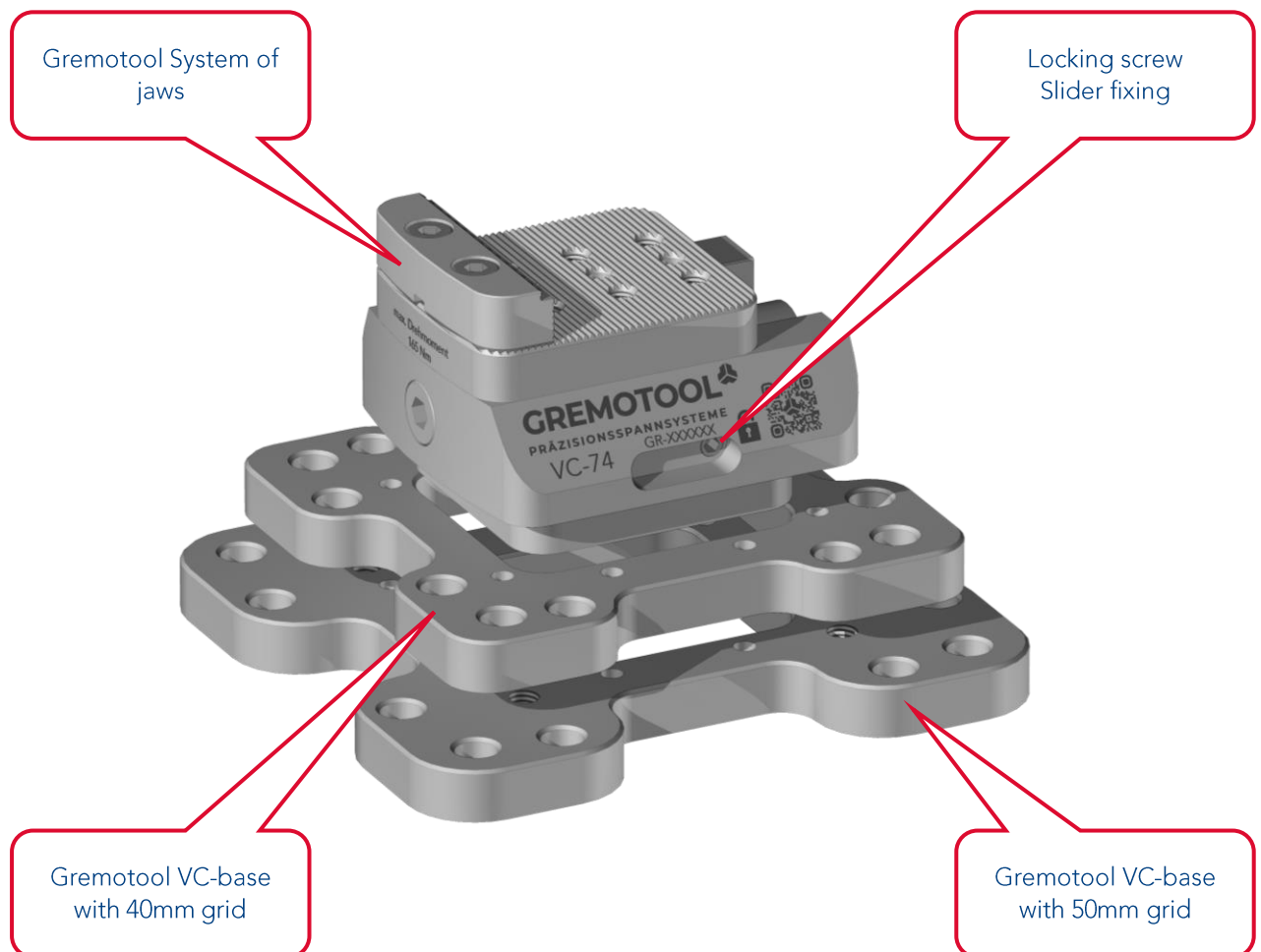

# Overview of size options

VC-Series

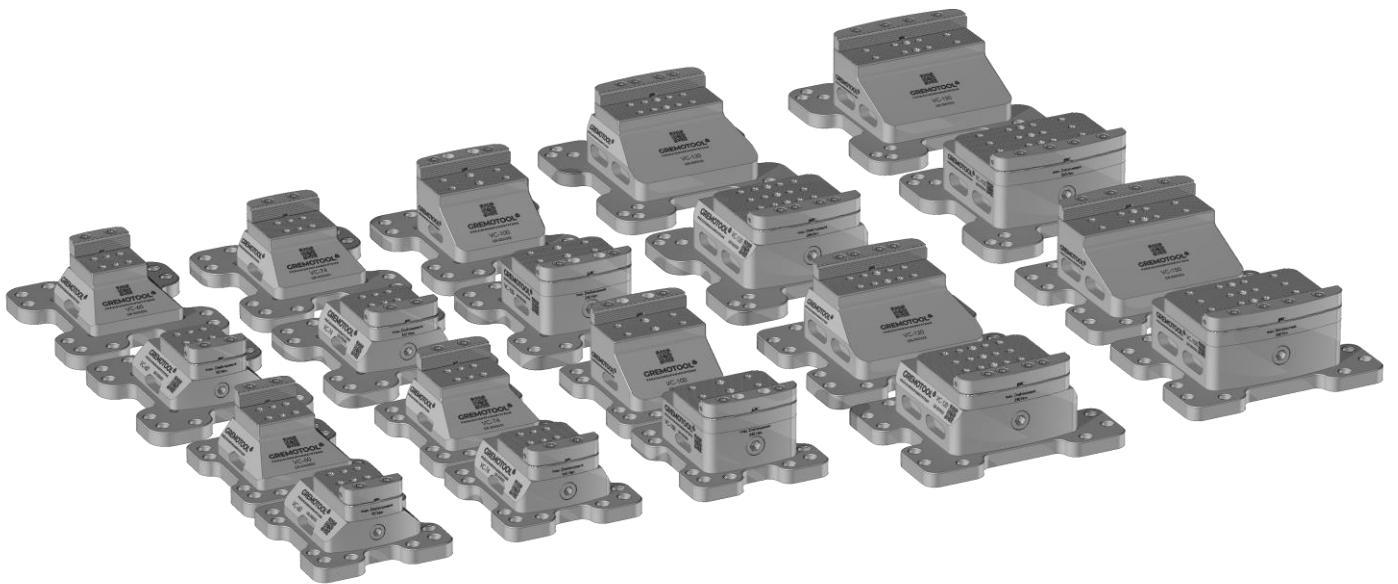

# Sizing guide

VC-Series



VC-Size		VC-60	VC-74	VC-100
Jaw width	[mm]	60	74	100
Clamping range	[mm]	> 50	> 50	> 50
Support height *	[mm]	75	75	85
Max. Torque range	[Nm]	95	165	240
Max. Clamping Force	[kN]	25	45	65
Total length (40mm/50mm grid)	[mm]	315 / 385	315 / 385	315 / 385
Total width (40mm/50mm grid)	[mm]	145 / 175	145 / 175	145 / 175
Total height **	[mm]	62	62	73
Spanner width	[mm]	8	10	12
Mass	[kg]	12.5	13.2	15.7

\* With standard SC-gripper jaw

\*\* without jaw

# Sizing guide

VC-Series

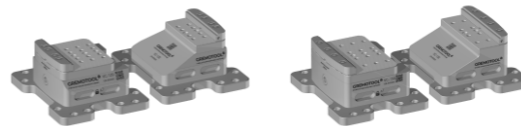

VC-Size		VC-120	VC-150
Jaw width	[mm]	120	150
Clamping range	[mm]	> 65	> 65
Support height *	[mm]	90	90
Max. Torque range	[Nm]	240	240
Max. Clamping Force	[kN]	65	65
Total length (40mm / 50mm grid)	[mm]	375 / 465	375 / 465
Total width (40mm / 50mm grid)	[mm]	220 / 215	220 / 215
Total height **	[mm]	78	78
Spanner width	[mm]	12	12
Mass	[kg]	25.2	27

\* With standard SC-gripper jaw

\*\* without jaw



# Torque range

VC-Series



VC-60

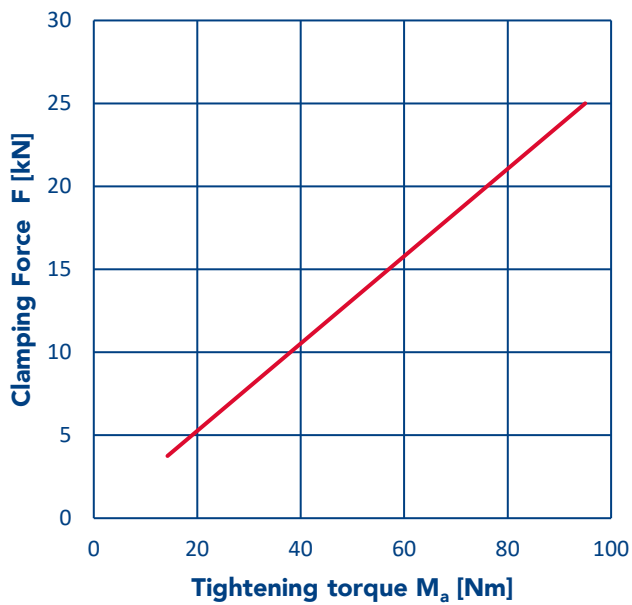

<b><math>M_a</math> max.</b>	95 Nm
------------------------------	-------

<b><math>M_a</math> min.</b>	14.25 Nm
------------------------------	----------

<b><math>F</math> max.</b>	25 kN
----------------------------	-------

<b><math>F</math> min.</b>	3.75 kN
----------------------------	---------



VC-74

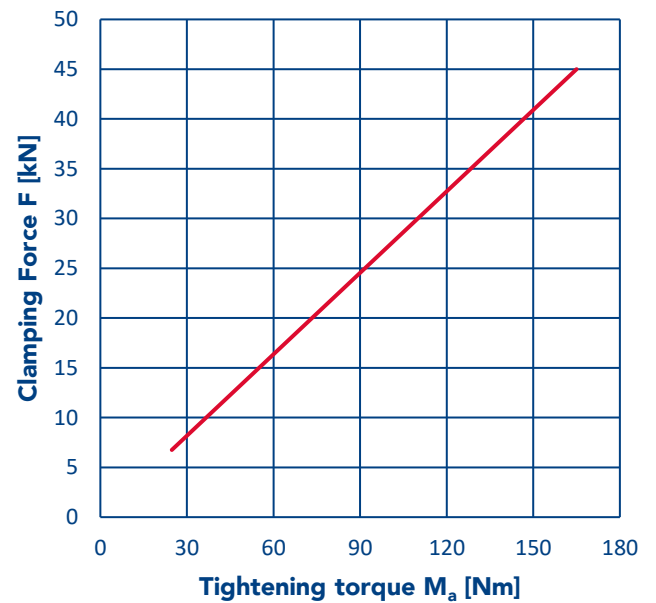

<b><math>M_a</math> max.</b>	165 Nm
------------------------------	--------

<b><math>M_a</math> min.</b>	24.75 Nm
------------------------------	----------

<b><math>F</math> max.</b>	45 kN
----------------------------	-------

<b><math>F</math> min.</b>	6.75 kN
----------------------------	---------

# Torque range

VC-Series



## VC-100 / VC-120 / VC-150

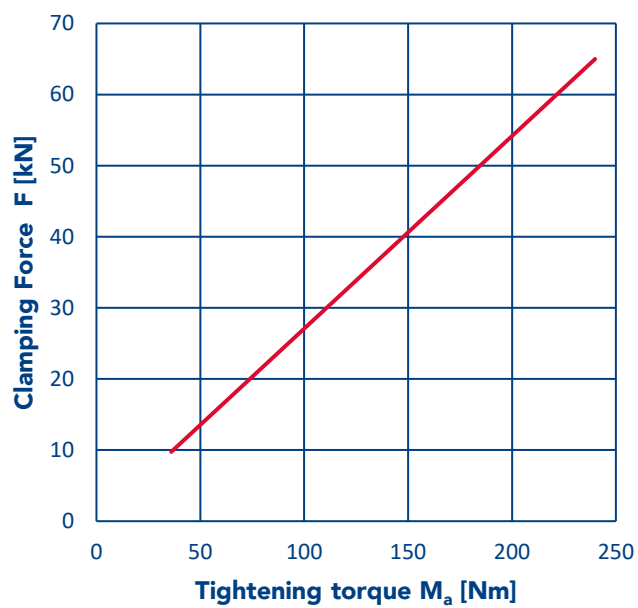

<b><math>M_a</math> max.</b>	240 Nm
<b><math>M_a</math> min.</b>	36 Nm
<b>F max.</b>	65 kN
<b>F min.</b>	9.75 kN

# Dimension

## VC-60 Clamping module 40mm grid

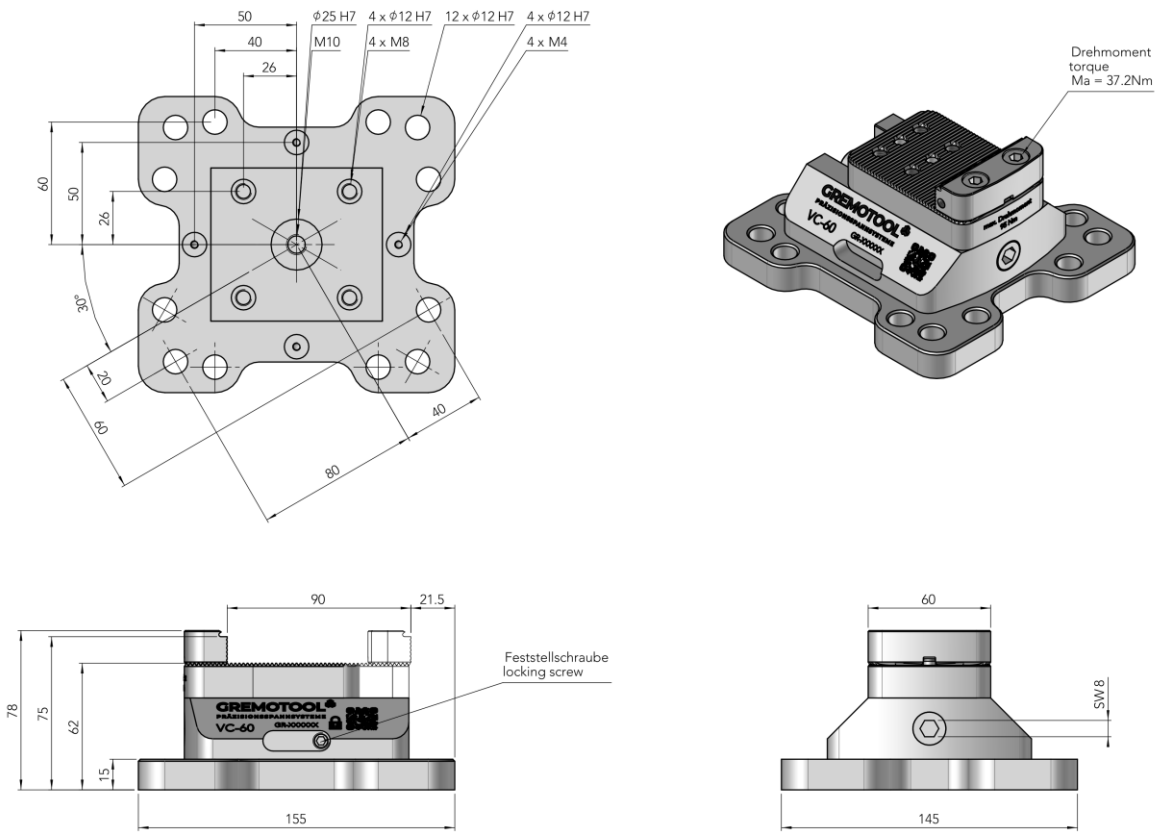

# Dimension

VC-60 Fixed module 40mm grid

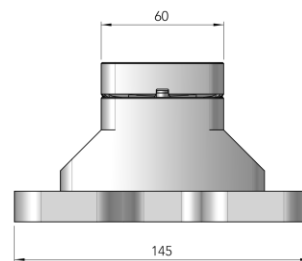
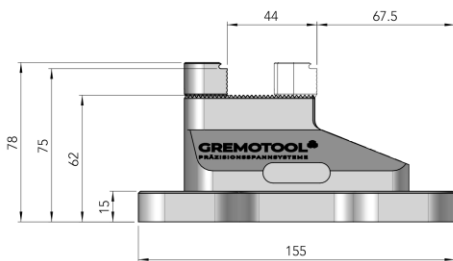
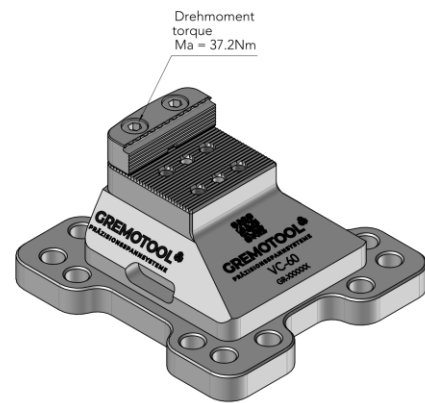
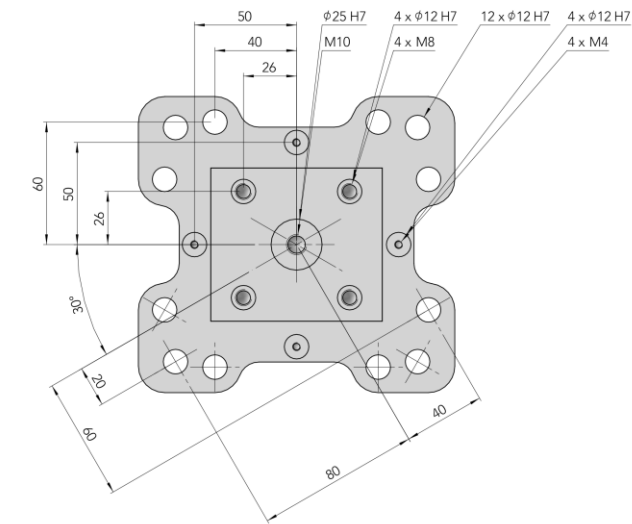

# Dimension

## VC-60 Clamping module 50mm grid

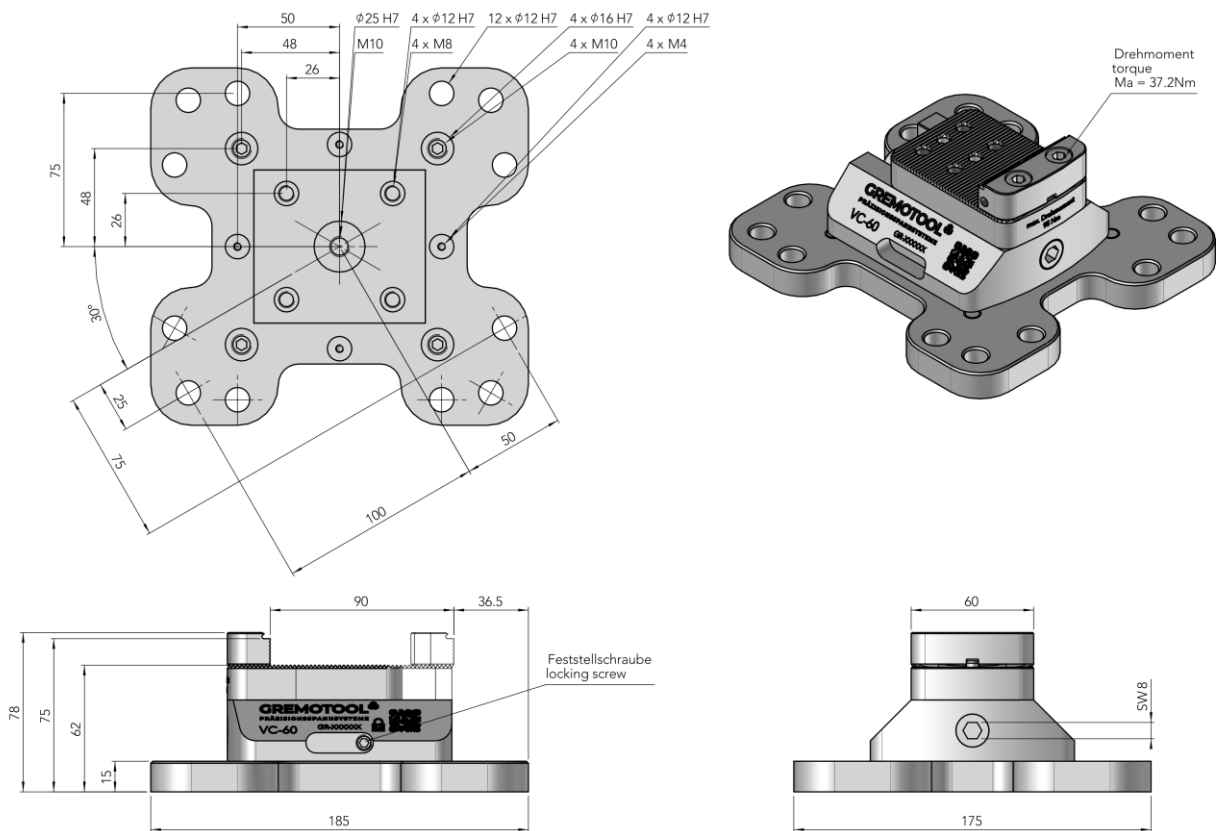

# Dimension

VC-60 Fixed module 50mm grid

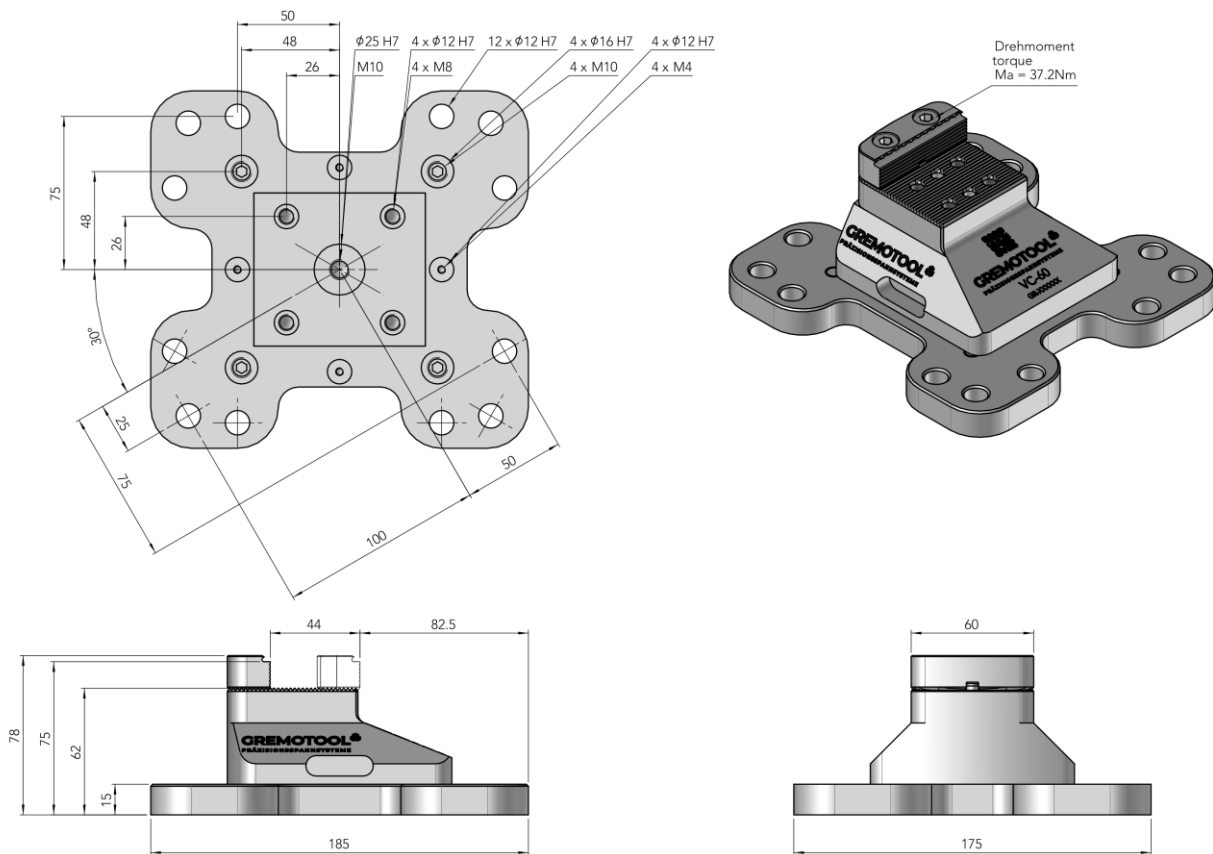

# Dimension

## VC-74 Clamping module 40mm gride

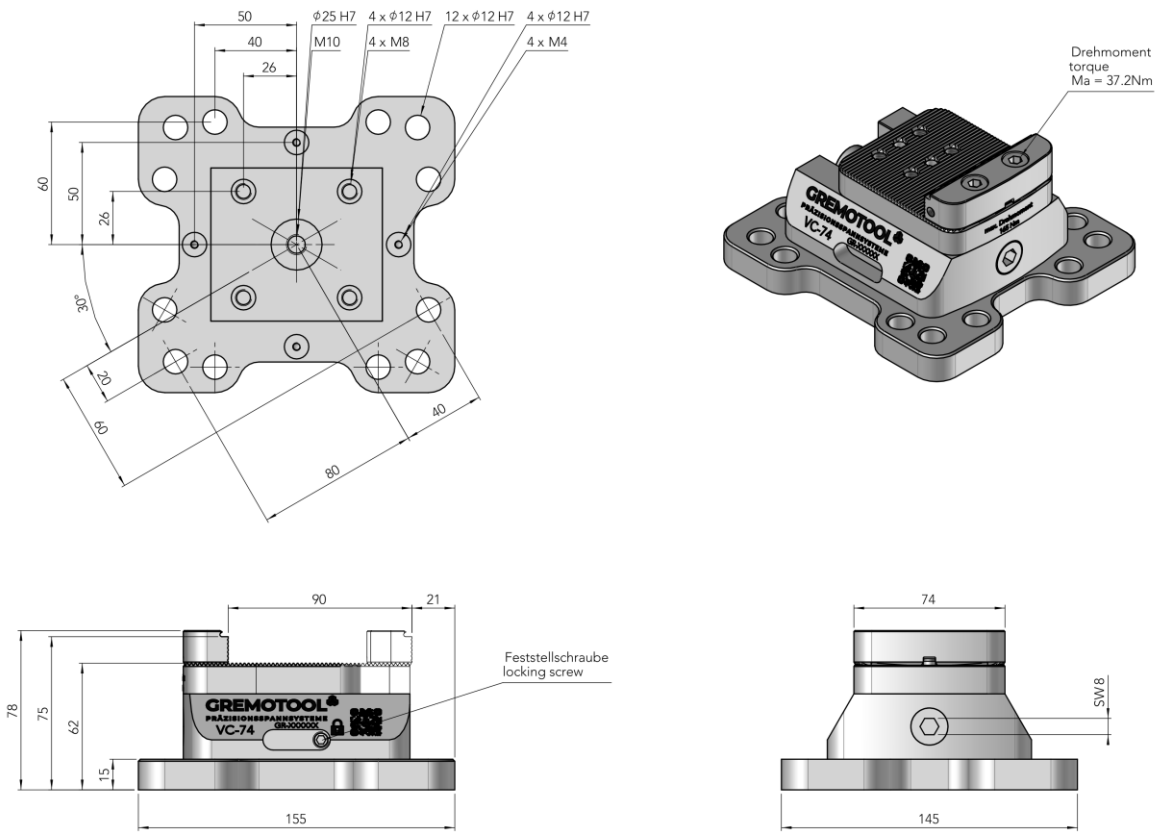

# Dimension

VC-74 Fixed module 40mm grid

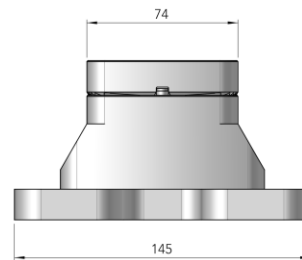
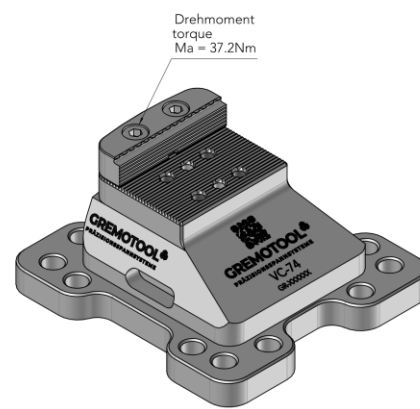
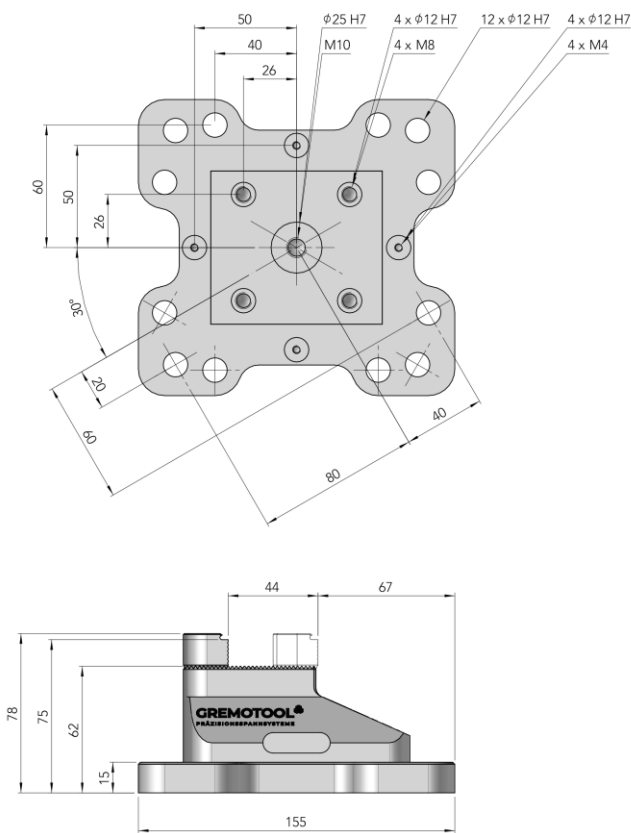



# Dimension

## VC-74 Clamping module 50mm grid

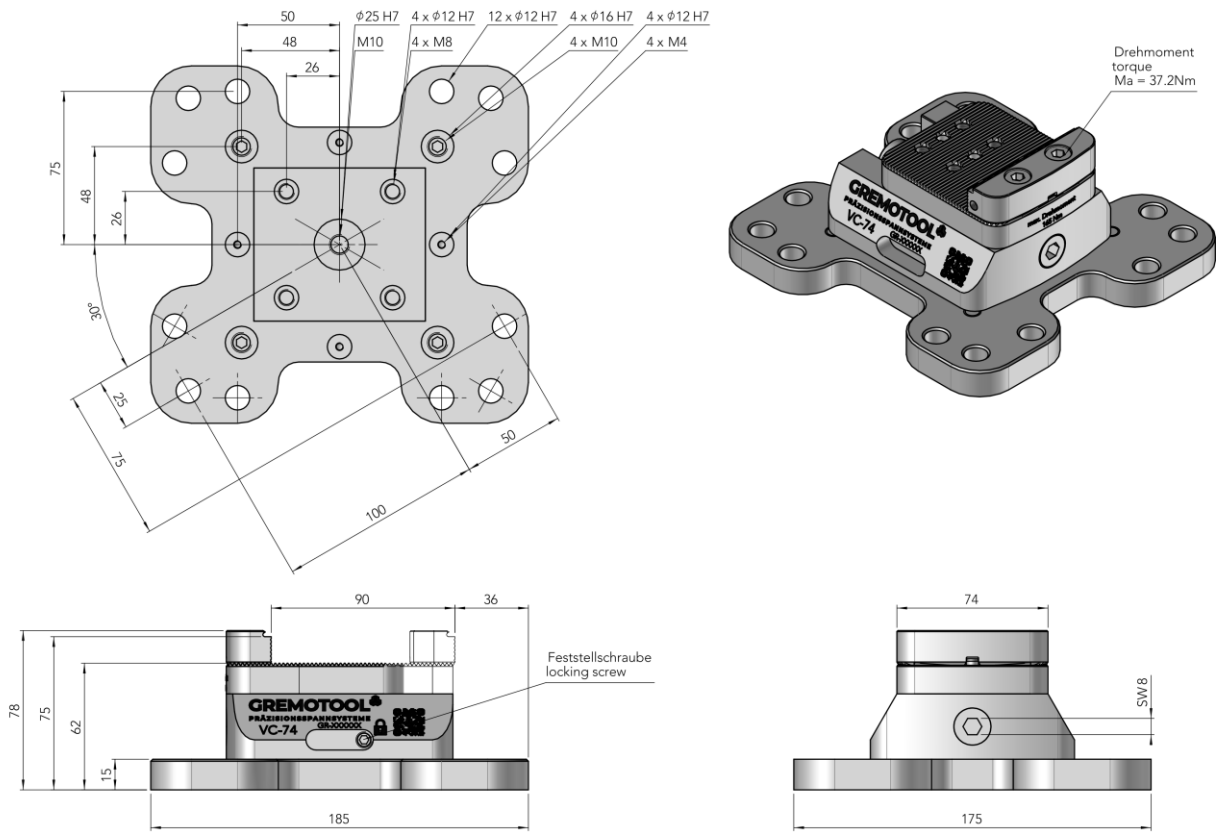

# Dimension

VC-74 Fixed module 50mm grid

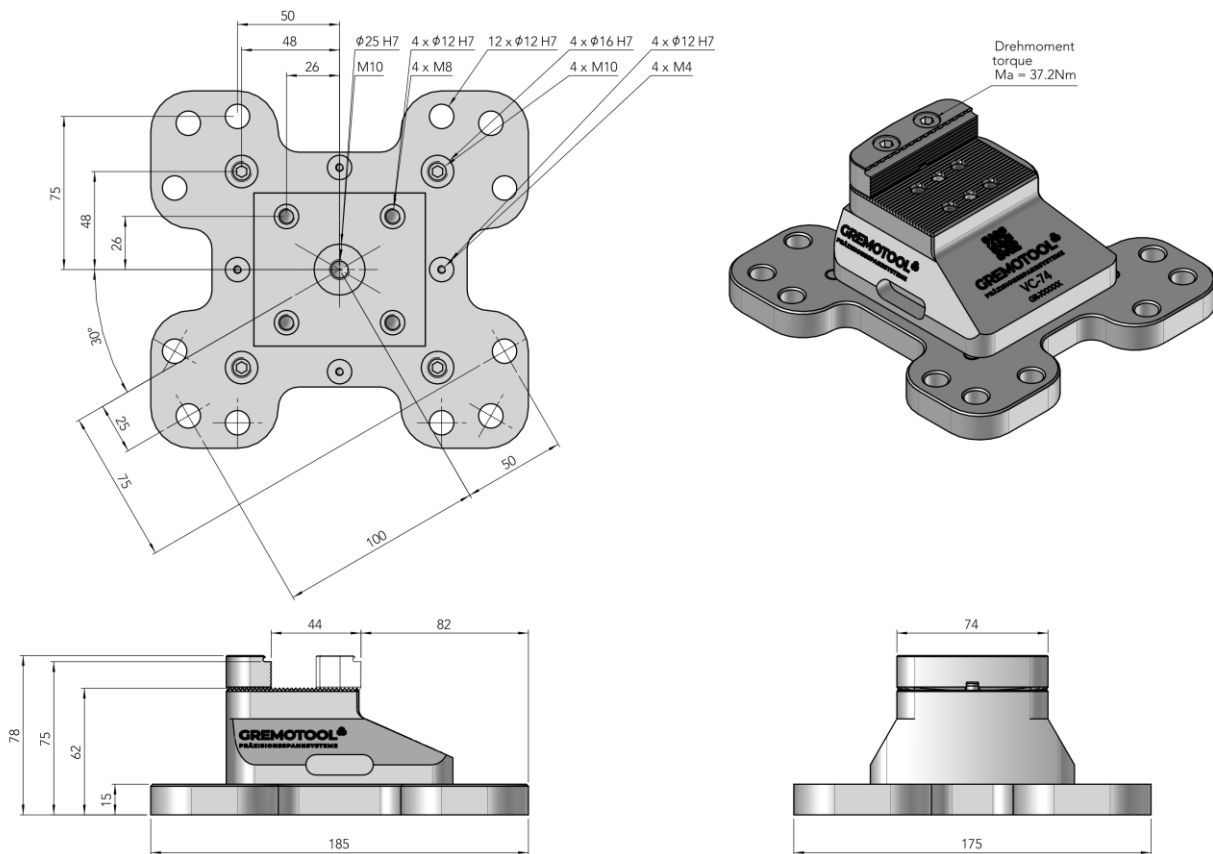

# Dimension

## VC-100 Clamping module 40mm grid

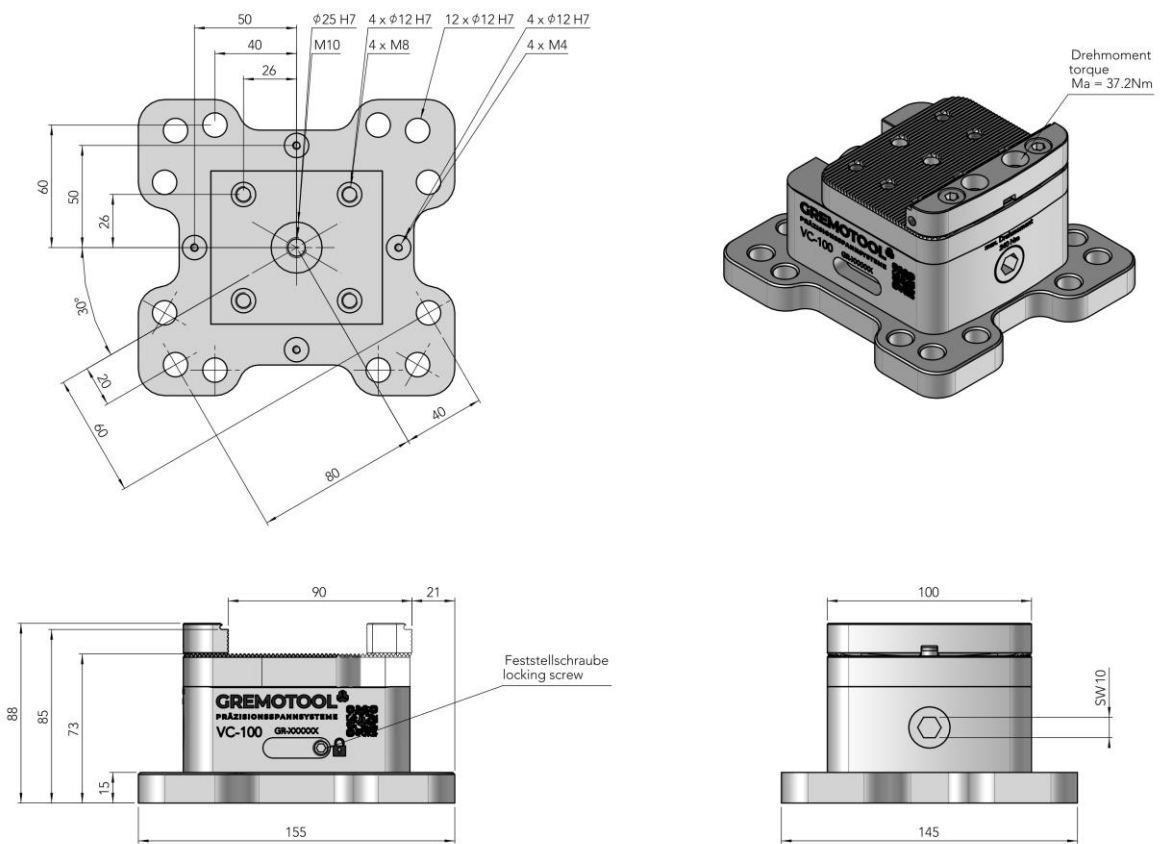

# Dimension

VC-100 Fixed module 40mm grid

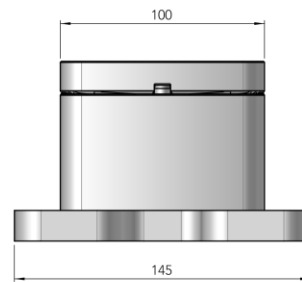
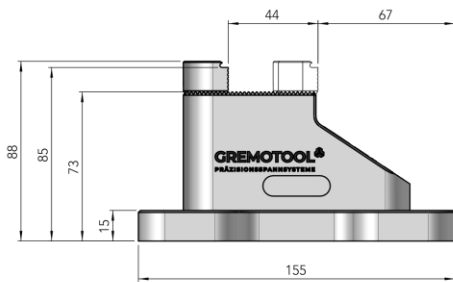
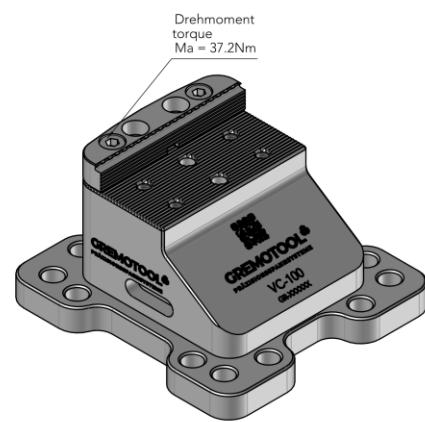
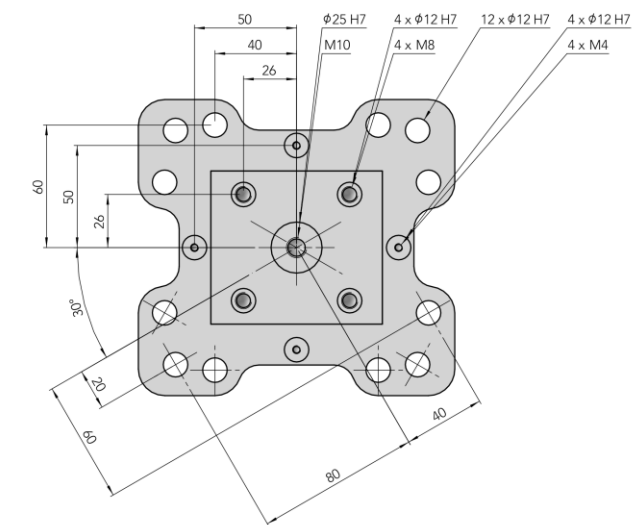

# Dimension

## VC-100 Clamping module 50mm grid

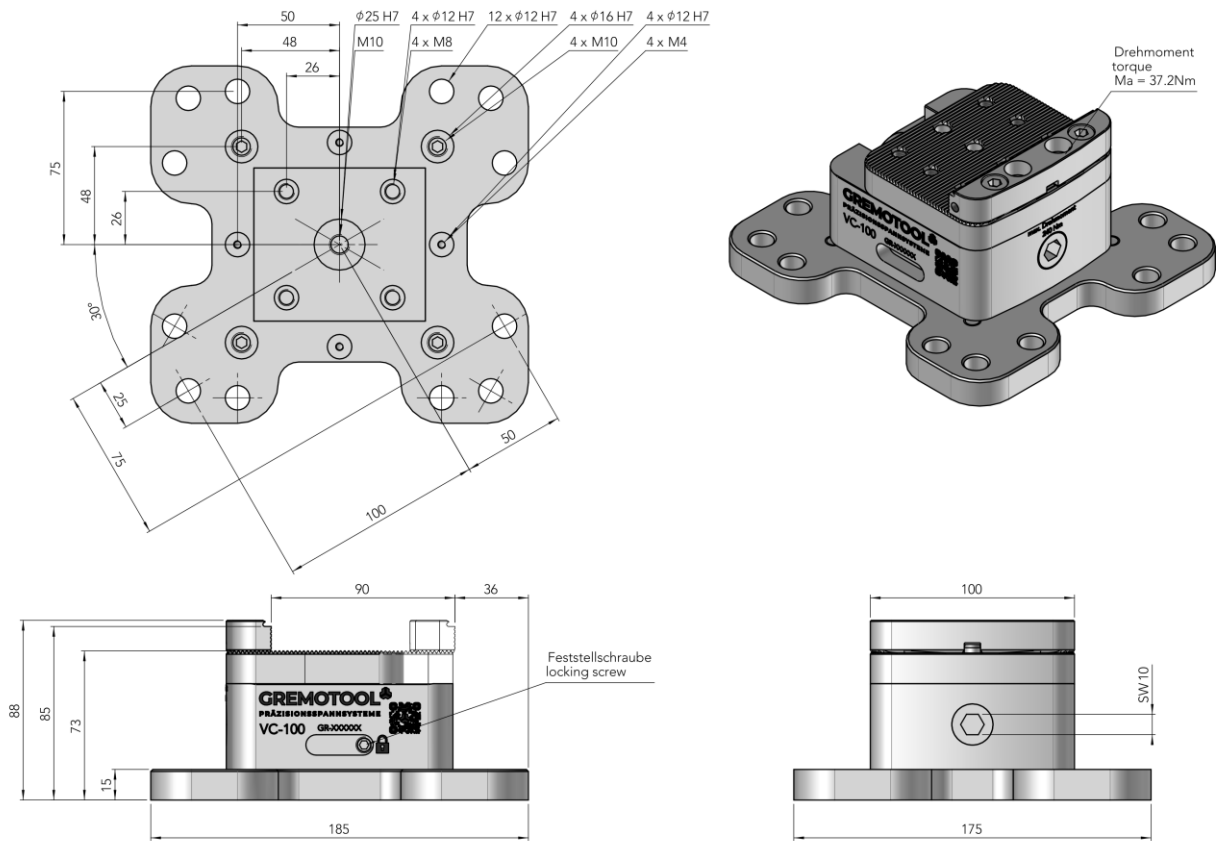

# Dimension

VC-100 Fixed module 50mm grid

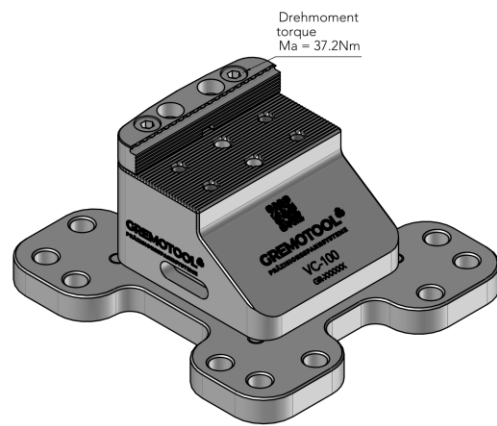
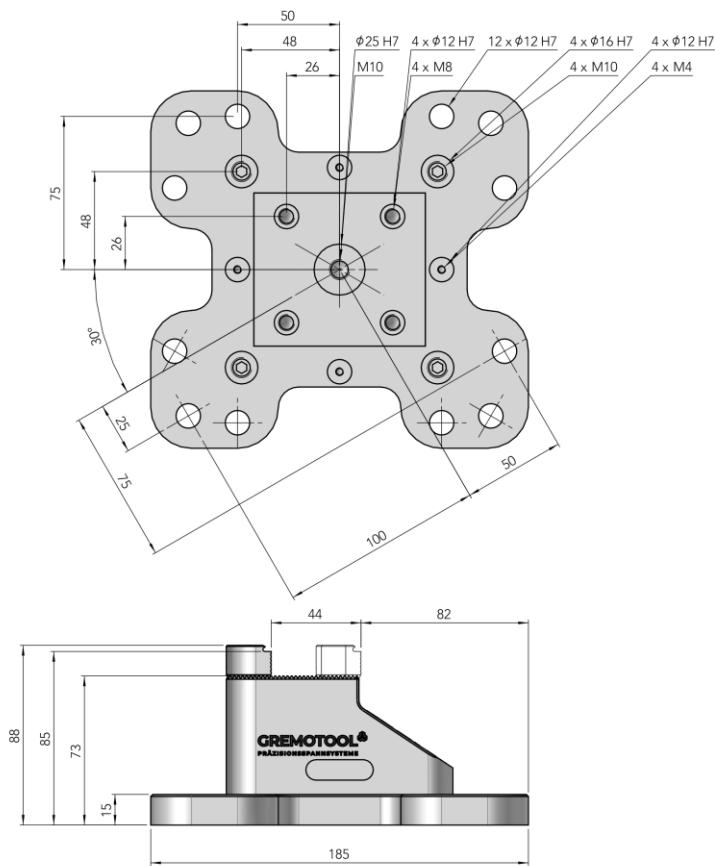

# Dimension

## VC-120 Clamping module 40mm grid

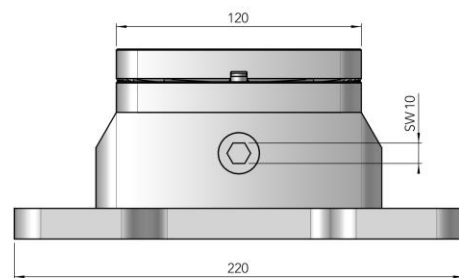
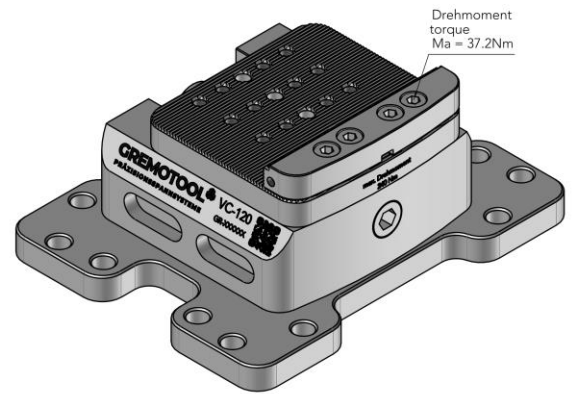
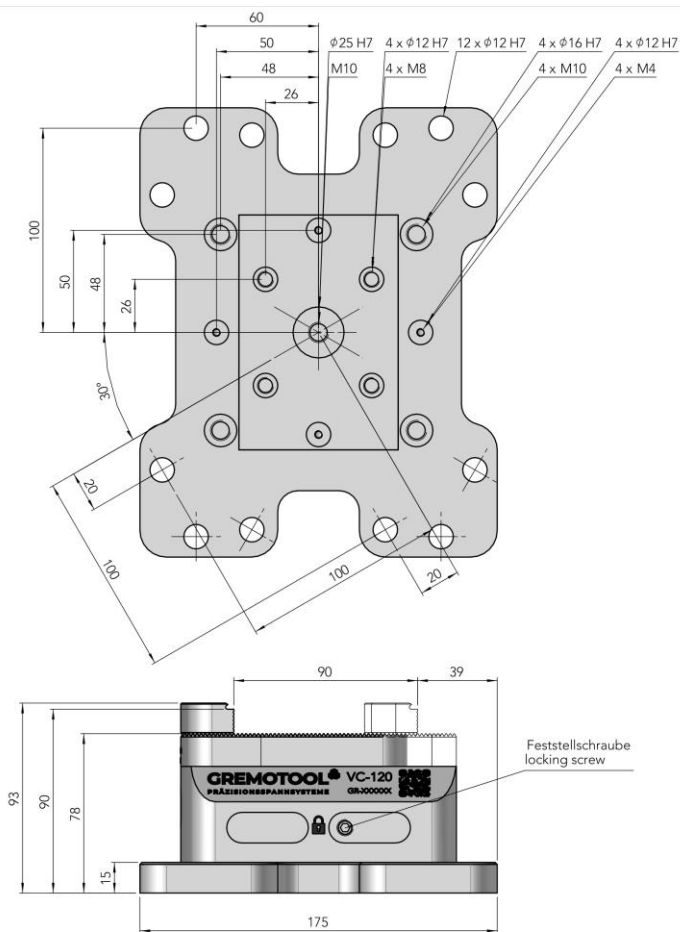

# Dimension

VC-120 Fixed module 40mm grid

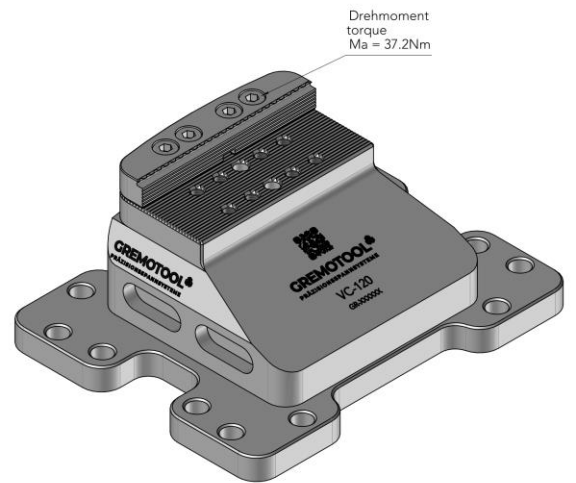
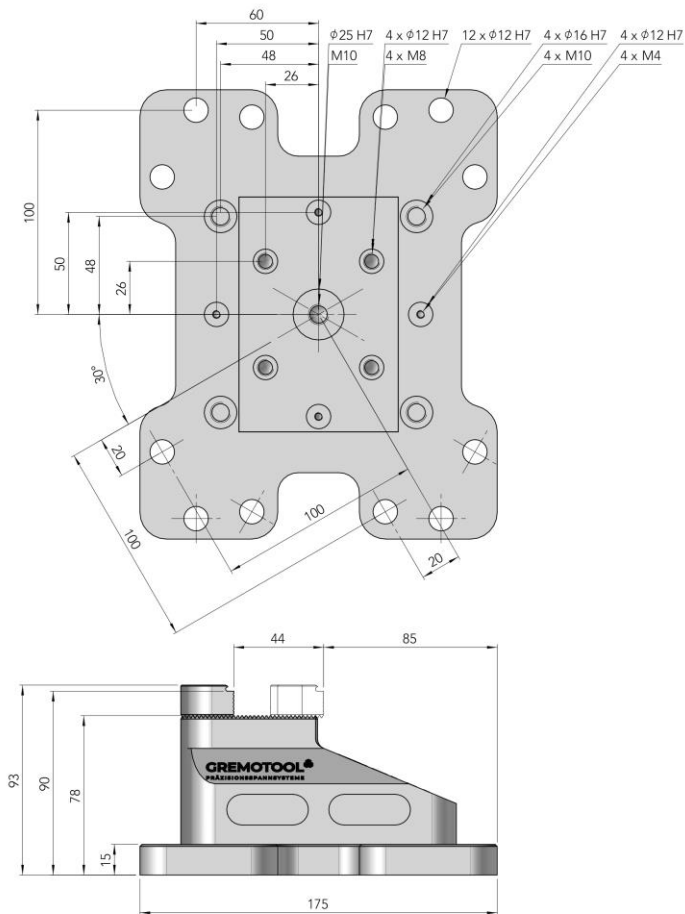



# Dimension

## VC-120 Clamping module 50mm grid

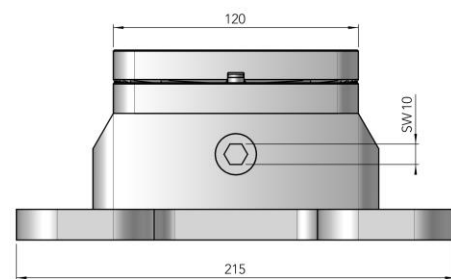
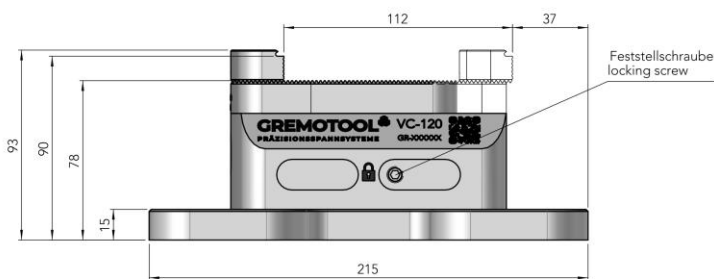
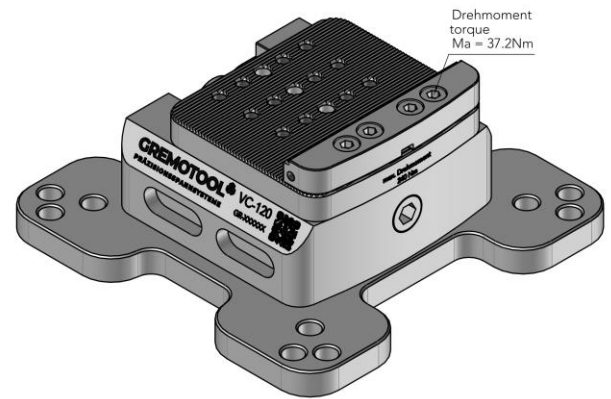
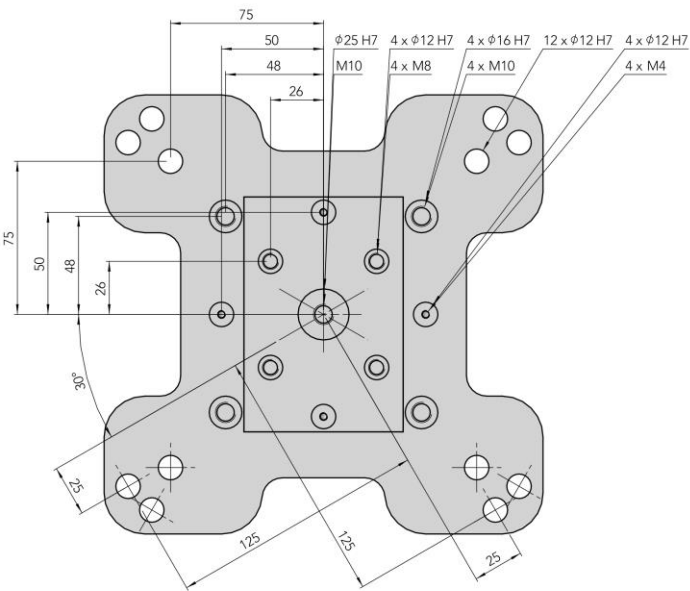

# Dimensionen

VC-120 Fixed module 50mm grid

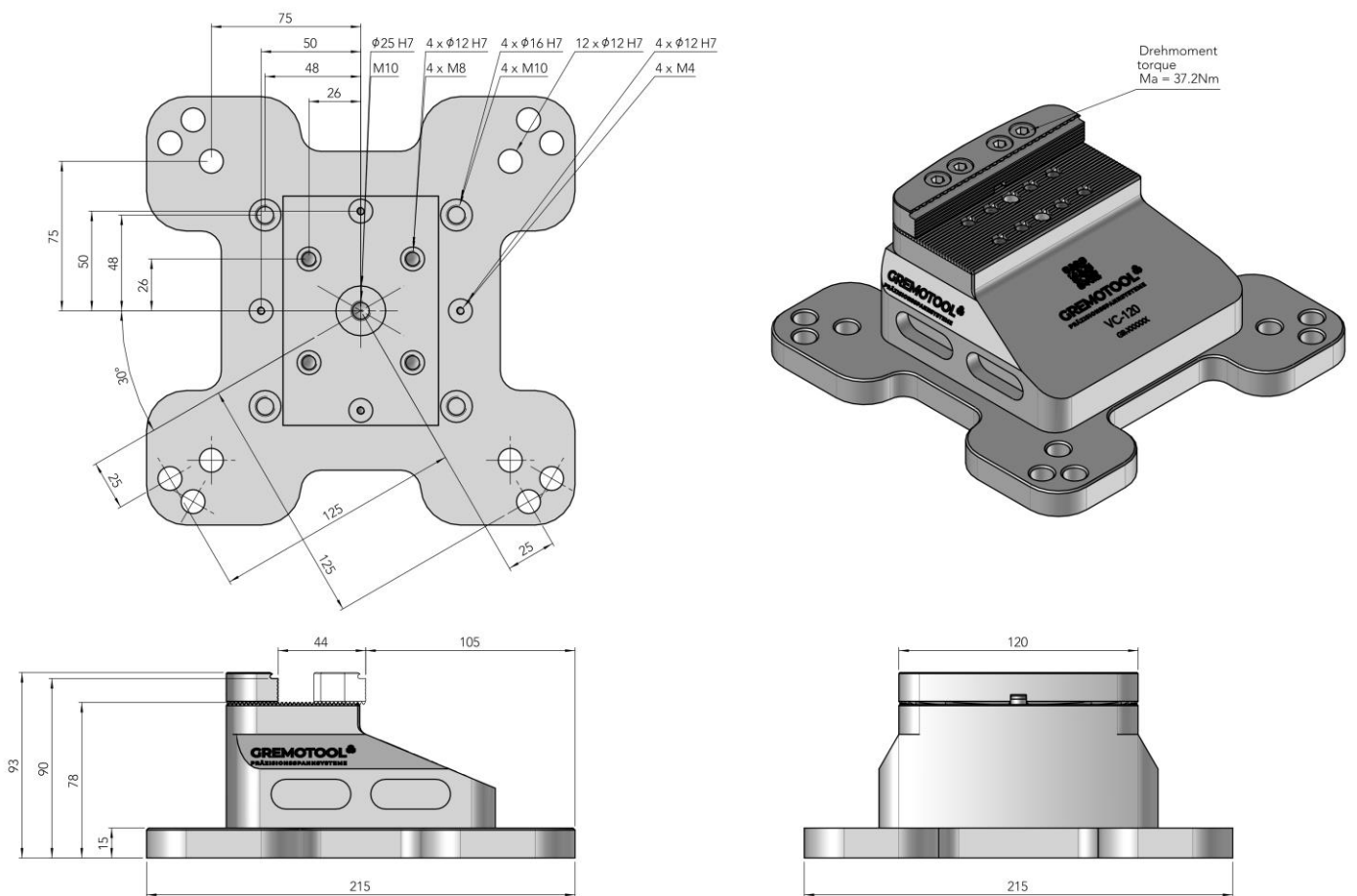

# Dimension

## VC-150 Clamping module 40mm grid

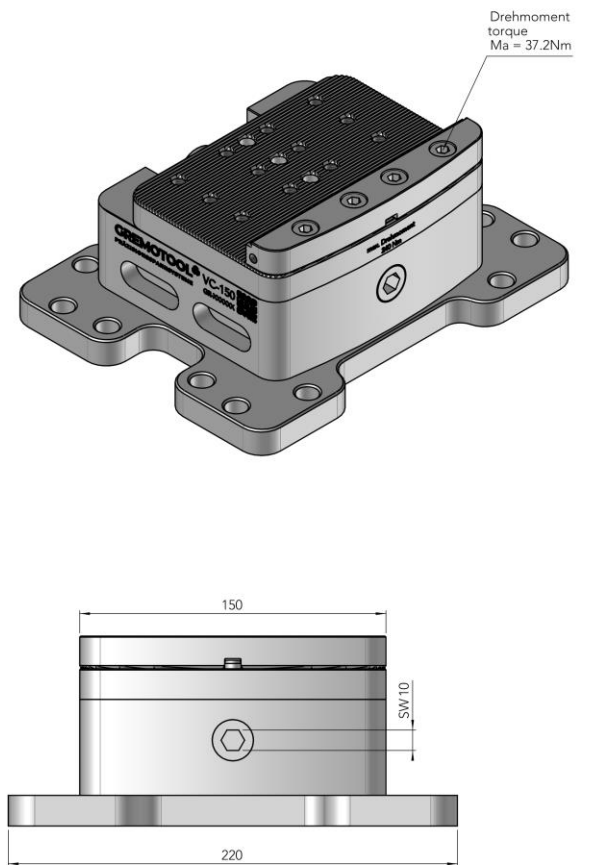
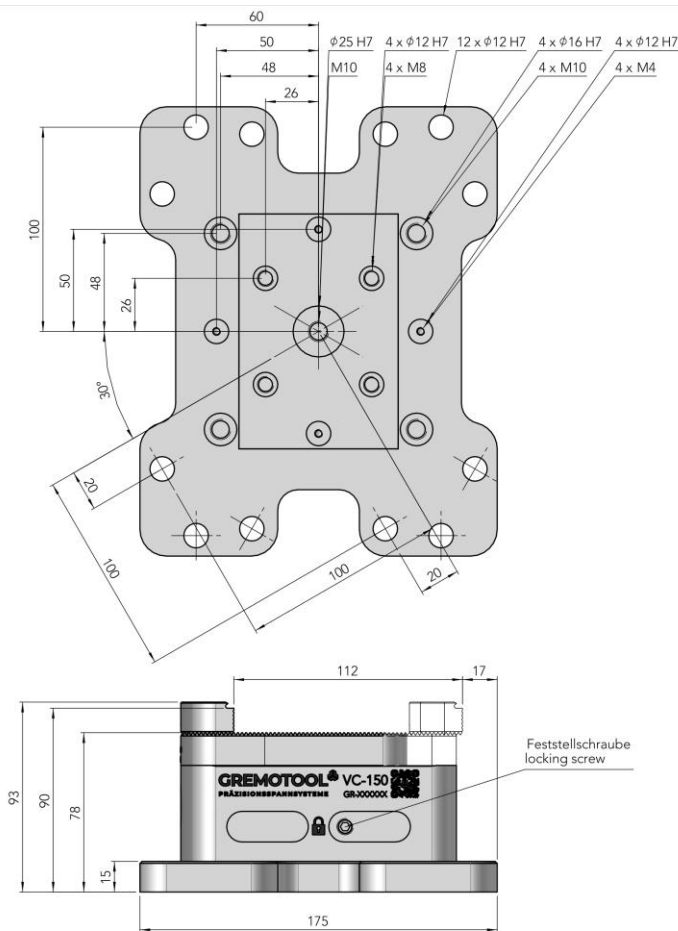

# Dimension

VC-150 Fixed module 40mm grid

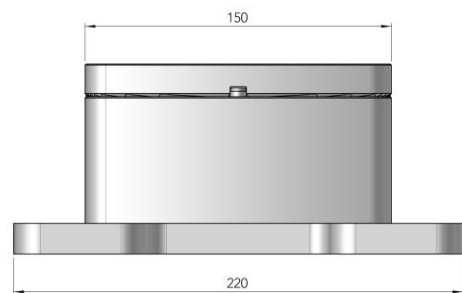
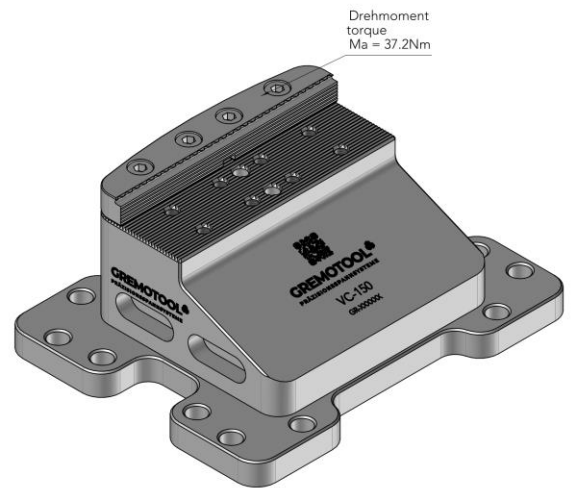
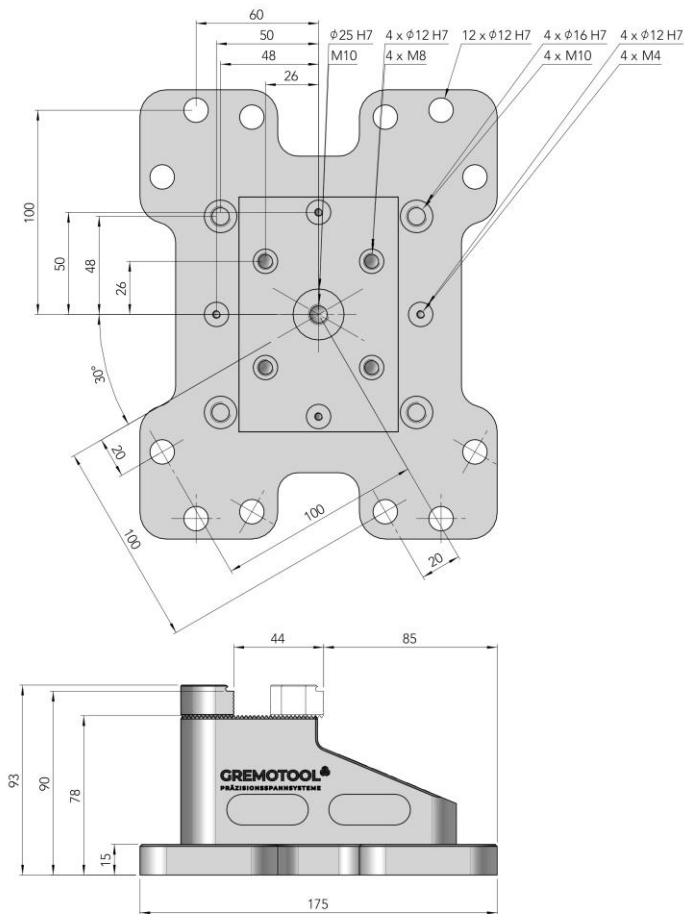

# Dimension

## VC-150 Clamping module 50mm grid

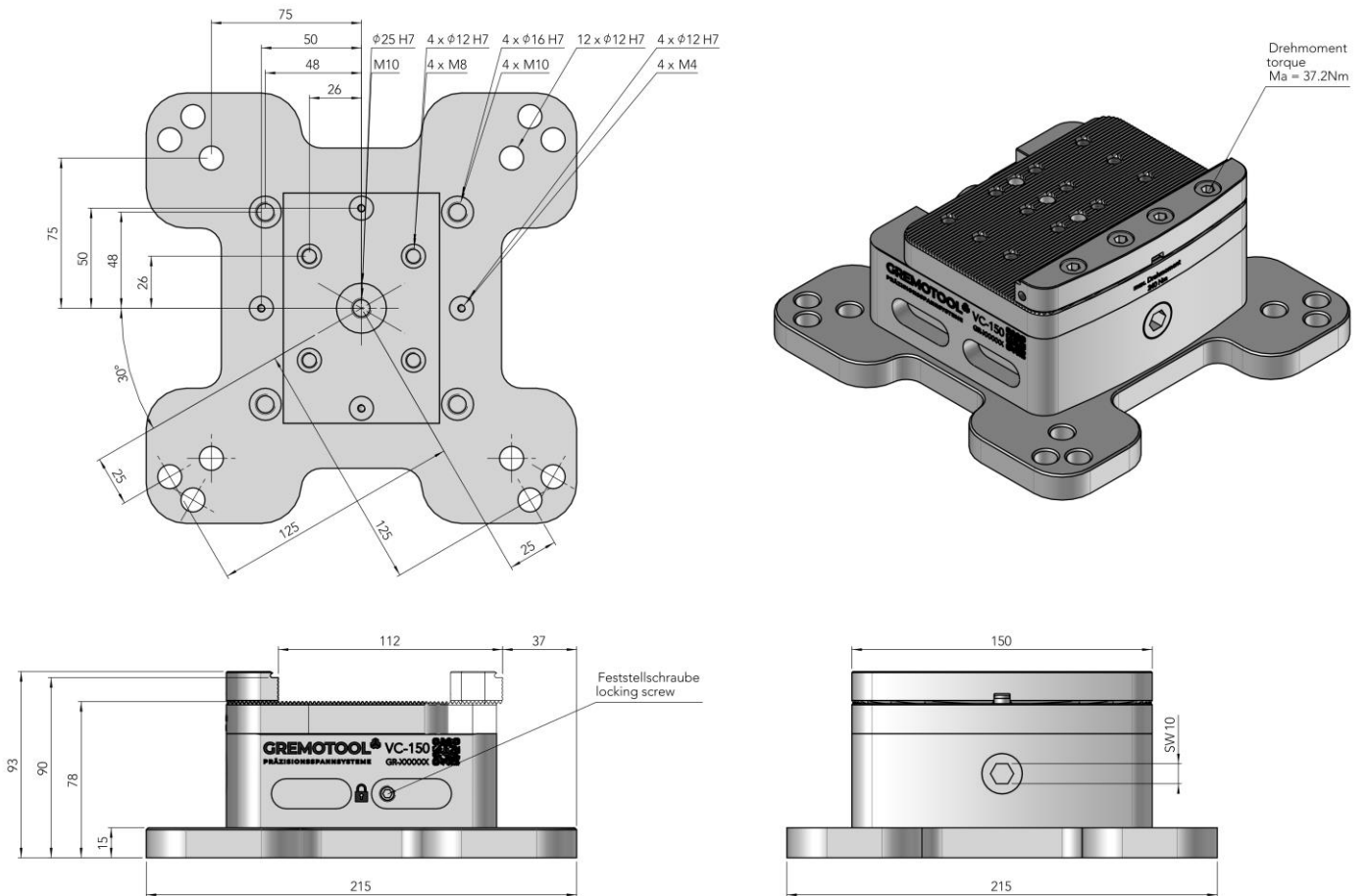

# Dimension

VC-150 Fixed module 50mm grid

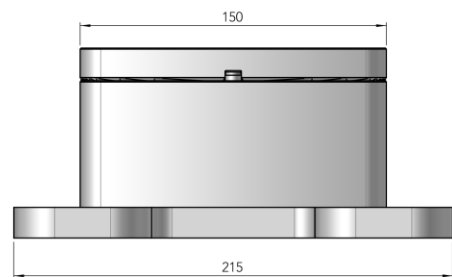
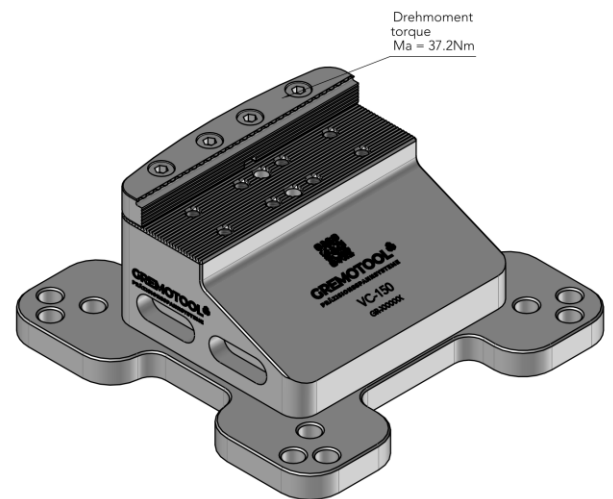
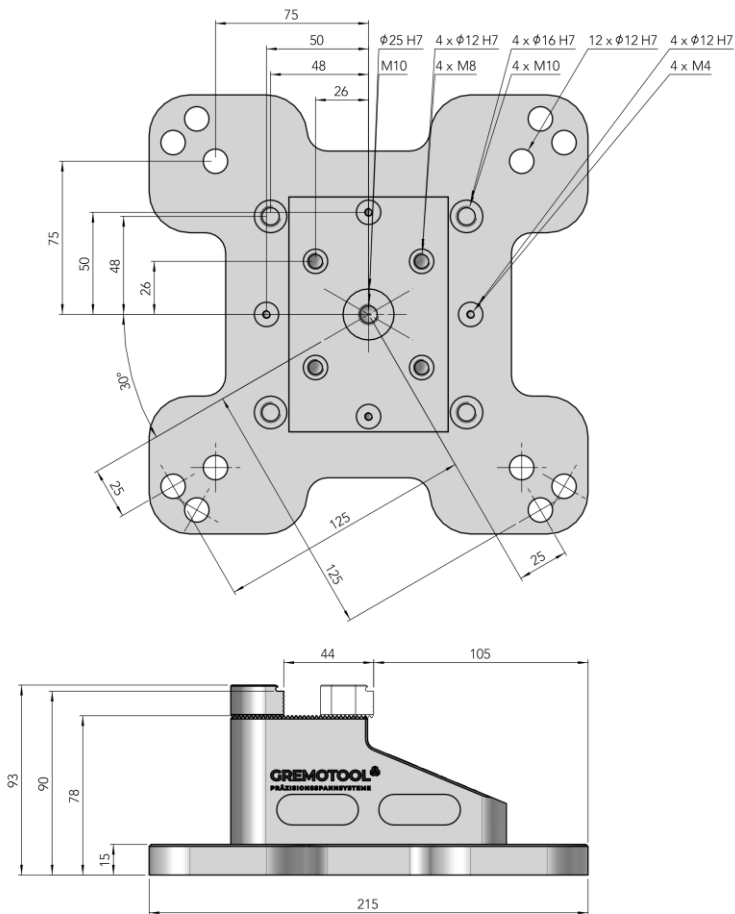

# Applications

## Fixture

The VC series is characterised by its flexibility in use. Thanks to the design, the two modules can be mounted independently of each other on different base plates or towers. This allows large panels or workpieces to be fixed without changing or converting the clamping device. The clamping modules can also be used for equalising clamping.

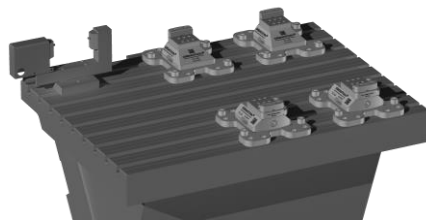

**Clamping Device:** 2x VC60  
**Fixture:** Table mounting

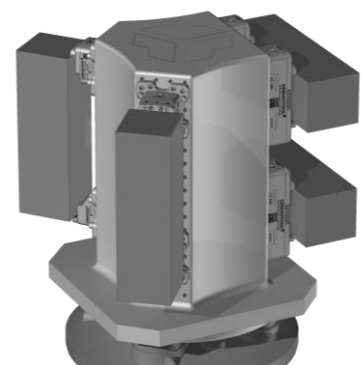

**Clamping Device:** 2x VC-100  
**Fixture:** Perforated grid tower

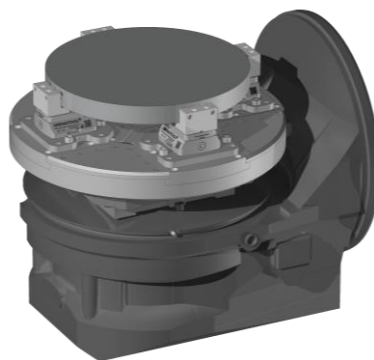

**Clamping Device:** 2x VC-74  
**Fixture:** Milling-Turning Base Plate



**Clamping Device:** 2x VC-74  
**Fixture:** Perforated grid plate

# Accessories

## Jaws

Pair of standard gripper jaws is supplied with each VersatileClamp, so, you are already able to clamp parts at no additional costs.

Width of jaws [mm]		34	40	50	60	74	100	120	150
<b>SC-gripper jaw flat</b>	<b>Nr. 837110</b>				X	X	X	X	X
<b>SC-gripper jaw</b>	<b>Nr. 837150</b>				X	X	X	X	X
<b>Standard gripper jaw</b>	<b>Nr. 837250</b>				X	X	X	X	X
<b>Height gripper jaw</b>	<b>Nr. 837300</b>				X	X	X	X	X
<b>Combi jaw</b>	<b>Nr. 837350</b>				X	X	X	X	X
<b>Automation gripper jaw</b>	<b>Nr. 837380</b>				X	X	X	X	X
<b>Automation step jaw</b>	<b>Nr. 837400</b>				X	X	X	X	X
<b>Step jaw flat</b>	<b>Nr. 837410</b>				X	X	X	X	X
<b>Standard step jaw</b>	<b>Nr. 837450</b>				X	X	X	X	X
<b>Prism jaw</b>	<b>Nr. 837500</b>				X	X	X	X	X
<b>Soft jaw Aluminium</b>	<b>Nr. 837702</b>				X	X	X	X	X
<b>Soft jaw Steel</b>	<b>Nr. 837703</b>				X	X	X	X	X

For the exact data of the jaws, please check the jaw catalogue.



# Accessories

## Jaws

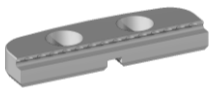

**Nr. 837110**

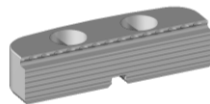

**Nr. 837150**

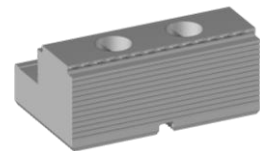

**Nr. 837250**

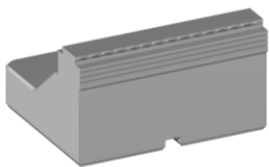

**Nr. 837300**

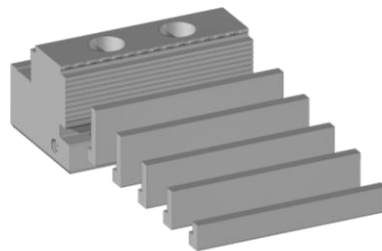

**Nr. 837350**

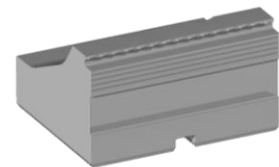

**Nr. 837380**

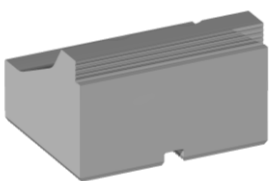

**Nr. 837400**

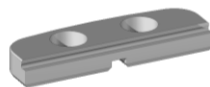

**Nr. 837410**

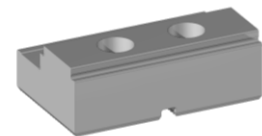

**Nr. 837450**

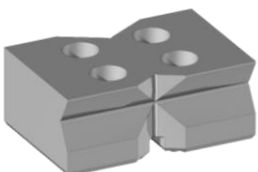

**Nr. 837500**

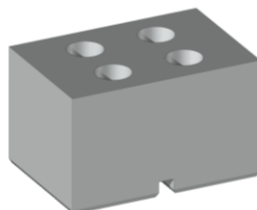

**Nr. 837702**

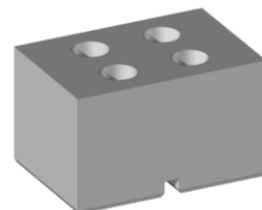

**Nr. 837703**



## Impressum

Gremotool GmbH  
Wilerstrasse 3  
CH-9200 Gossau  
Schweiz

[www.gremotool.ch](http://www.gremotool.ch)  
[info@gremotool.ch](mailto:info@gremotool.ch)  
+41 (0)71 930 03 90

Our general terms and conditions  
apply, which can be accessed at  
[www.gremotool.ch](http://www.gremotool.ch)

Further catalogues can be  
downloaded from the website  
[www.gremotool.ch](http://www.gremotool.ch).

Commercial Register:  
UID-Nr. CHE-498.310.590

This document is protected by  
copyright. All rights reserved. Any use,  
even partial use, in particular  
publication, duplication, distribution,  
reproduction, processing and/or  
modification, requires the prior written  
authorisation of Gremotool GmbH.  
Misprints, errors, and technical  
changes reserved.

Publication January 2024, 1st Edition

